

NOTES:

- 1. SUBSTRATE:
Silicon
- 2. COATING (APPLY ACROSS COATING APERTURE):
S1 & S2: R(AVG) ≤0.5% @ 1250 - 1620
- 3. WORKING DISTANCE (mm):
1.1143
- 4. MODE FIELD DIAMETER (mm):
Source: 0.0104
Target: 0.25
- 5. ACTIVE LENSES CENTERED ON SUBSTRATE
- 6. ROHS: COMPLIANT

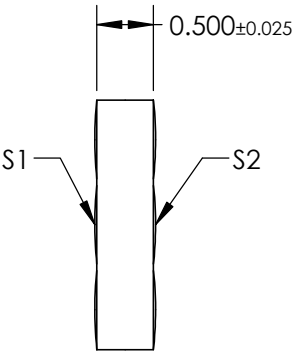
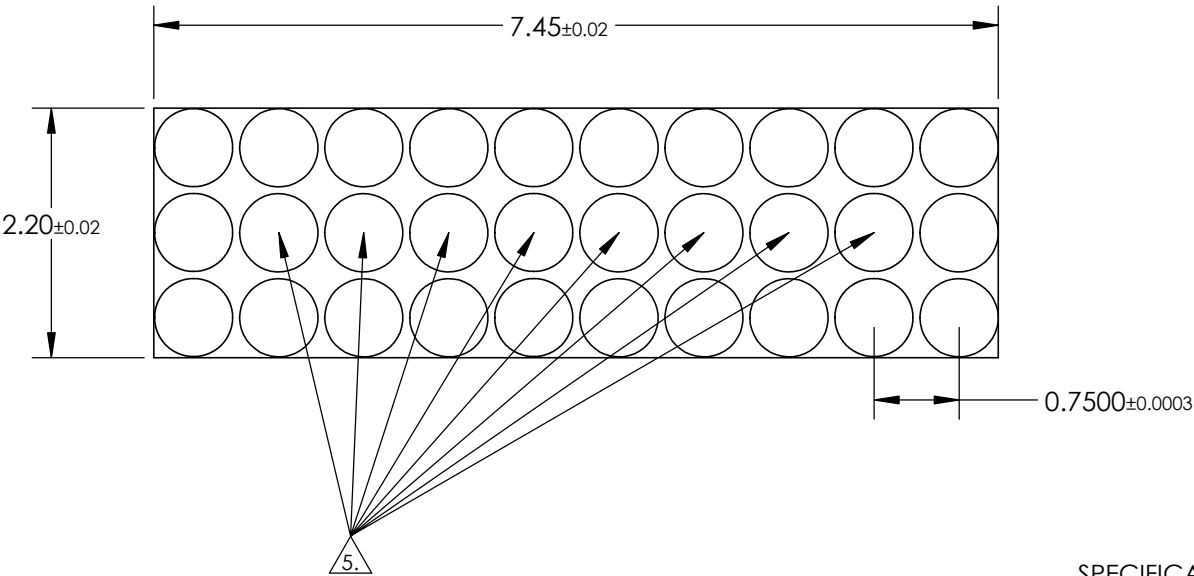
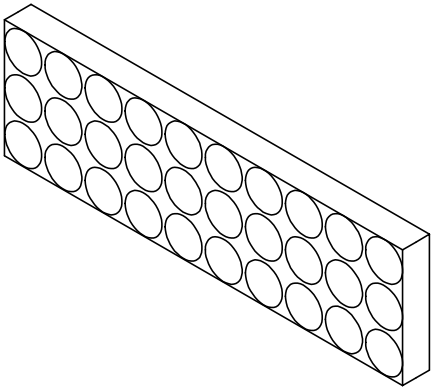

SPECIFICATIONS SUBJECT TO CHANGE WITHOUT NOTICE
DIMENSIONS ARE FOR REFERENCE ONLY

**FOR INFORMATION ONLY:
DO NOT MANUFACTURE
PARTS TO THIS DRAWING**

Edmund Optics®

THIRD ANGLE PROJECTION		TITLE	7.45 x 2.20mm, 3.200 ROC, 750µm Pitch, Silicon, 1 x 8 Linear Microlens Array	
ALL DIMS IN	mm	DWG NO	21179	SHEET 1 OF 1