

NOTES:

- 1. SUBSTRATE:
SILICON FLOATZONE
- 2. TRANSMISSION (%): $\geq 85\%$
- 3. CUT-ON WAVELENGTH: 950nm

4. FINE GRIND SURFACE

5. POWER, IRREGULARITY, AND SURFACE QUALITY SPECIFICATION APPLY
ACROSS CLEAR APERTURE

6. RoHS: COMPLIANT

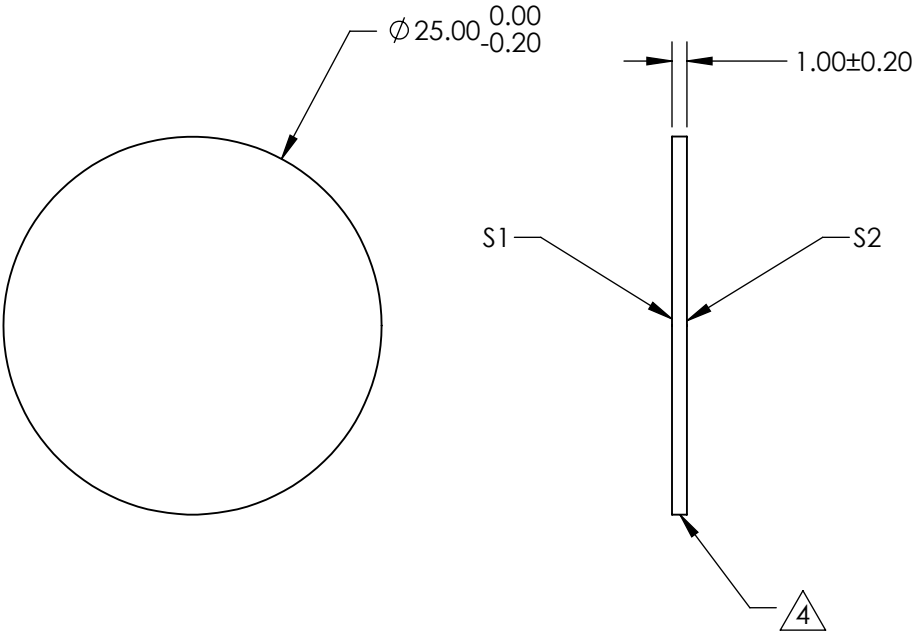
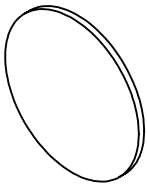

**FOR INFORMATION ONLY:
DO NOT MANUFACTURE
PARTS TO THIS DRAWING**

SPECIFICATIONS SUBJECT TO CHANGE WITHOUT NOTICE
DIMENSIONS ARE FOR REFERENCE ONLY

Rev. A	S1	S2
SHAPE	PLANO	PLANO
SURFACE QUALITY	80-50	80-50
COATING APERTURE	Ø20	Ø20
BEVEL	PROTECTED AS NEEDED	PROTECTED AS NEEDED

THIRD ANGLE
PROJECTION

ALL DIMS IN mm

Edmund Optics®

TITLE	9.5µm 25mm Diameter, IR Shortpass Filter
DWG NO	21257
SHEET	4 OF 5