

NOTES:

- 1. SUBSTRATE: Fused Silica
- 2. SURFACE S2 TO BE PARALLEL WITH SURFACE S1 TO WITHIN <3 ARCMIN
- 3. COATING (APPLY ACROSS CLEAR APERTURE)

S1: R(ABS) >99.5% @ 532 & 1064nm @ 45° AOI  
DAMAGE THRESHOLD:  
15 J/cm2 @ 20ns @ 532nm  
20 J/cm2 @ 20ns @ 1064nm

S2: NONE

4. COMMERCIAL POLISHED

5. POWER, IRREGULARITY, AND SURFACE QUALITY SPECIFICATION APPLY  
ACROSS CLEAR APERTURE

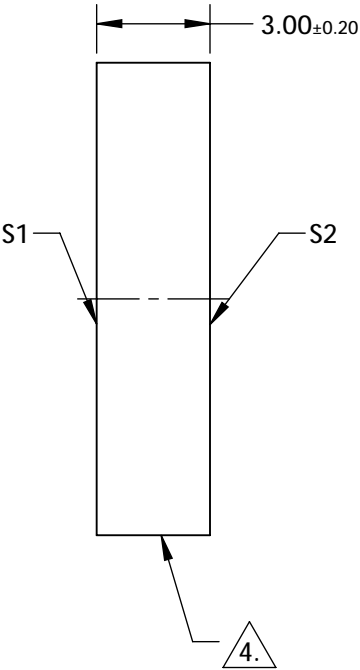
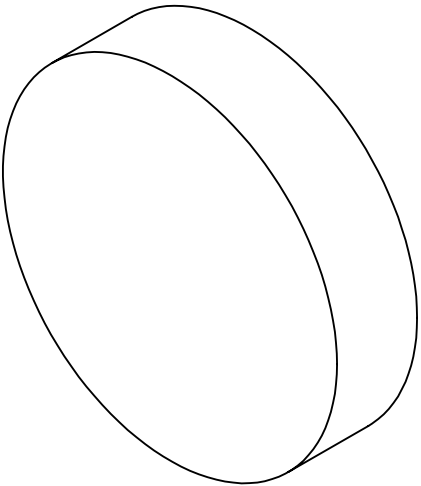
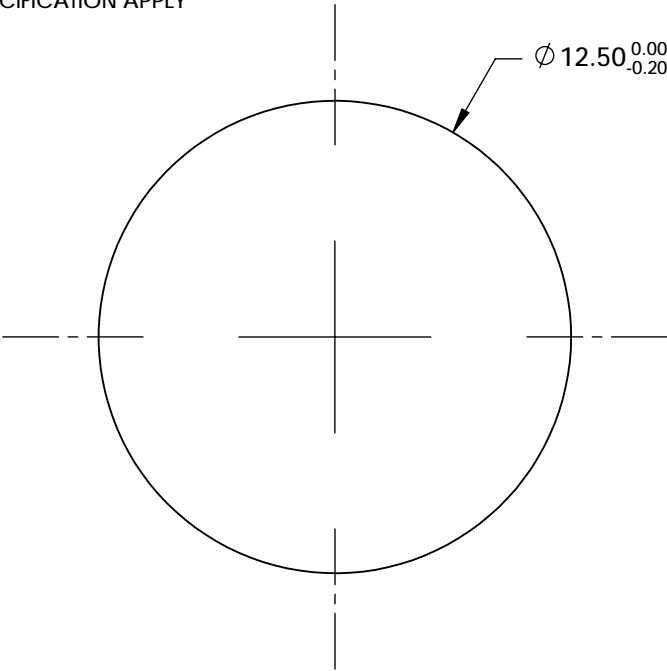

**FOR INFORMATION ONLY:  
DO NOT MANUFACTURE  
PARTS TO THIS DRAWING**

SPECIFICATIONS SUBJECT TO CHANGE WITHOUT NOTICE  
DIMENSIONS ARE FOR REFERENCE ONLY

	S1	S2
SHAPE	PLANO	PLANO
SURFACE QUALITY	10-5	NA
CLEAR APERTURE	11.25	NA
BEVEL	PROTECTED AS NEEDED	PROTECTED AS NEEDED

THIRD ANGLE  
PROJECTION

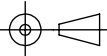

ALL DIMS IN

mm



Edmund Optics®

TITLE

12.5mm Dia. x 3mm 532/1064nm, Dual Band  
Laser Mirror

DWG NO

20371

SHEET  
1 OF 1