

NOTES:

1. SUBSTRATE MATERIAL:
FUSED SILICA
2. COATING (APPLY ACROSS CLEAR APERTURE)

S1 & S2: DIELECTRIC
TRANSMISSION (%): ≥93 (wavelength dependent)
DAMAGE THRESHOLD, PULSED:
63.4 J/cm2 @1064nm, 10ns
2.2 J/cm2 @1030nm, 212fs

4. DESIGN WAVELENGTH: 515nm
5. RoHS COMPLIANT

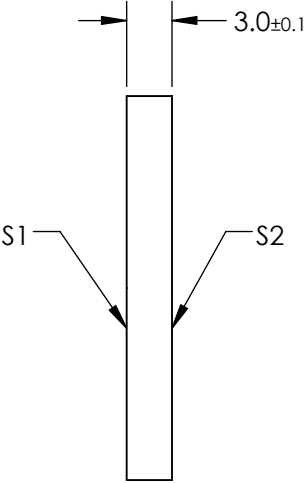
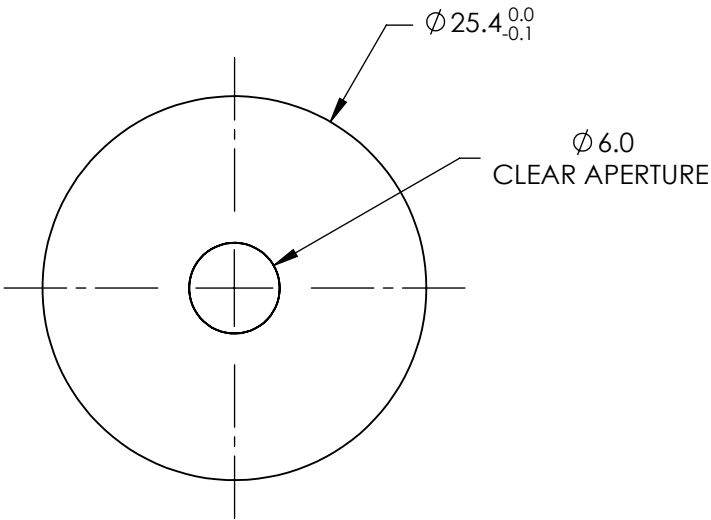

**FOR INFORMATION ONLY:
DO NOT MANUFACTURE
PARTS TO THIS DRAWING**

SPECIFICATIONS SUBJECT TO CHANGE WITHOUT NOTICE
DIMENSIONS ARE FOR REFERENCE ONLY

	S1	S2	<div><div><div><div></div><div></div></div><div><div></div><div></div></div></div><div>Edmund Optics®</div></div>			
SHAPE	PLANO	PLANO	<div>THIRD ANGLE PROJECTION</div> <div></div>	TITLE	515nm Higher Order Radial Polarization Converter (S-waveplate)	
SURFACE QUALITY	20-10	20-10		DWG NO	16793	SHEET 1 OF 1
SURFACE FLATNESS	$\lambda/8$	$\lambda/8$		ALL DIMS IN	mm	
BEVEL	PROTECTED AS NEEDED	PROTECTED AS NEEDED				