

NOTES:

- 1. SUBSTRATE: FLOAT GLASS
- 2. ROHS: COMPLIANT
- 3. COATING (APPLY ACROSS CLEAR APERTURE):

S1:
ABRASION: SEVERE, PER MIL-C-675C Paragraph 3.8.4.1
ADHESION: MIL-PRF-13830B, App B PARA. 4.4.6

R(AVG) >70% @ 400 - 700nm
R(AVG) >90% @ 2000 - 10000nm

S2: NONE

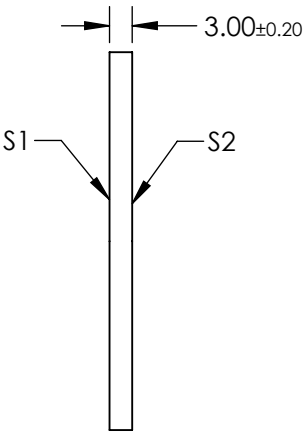
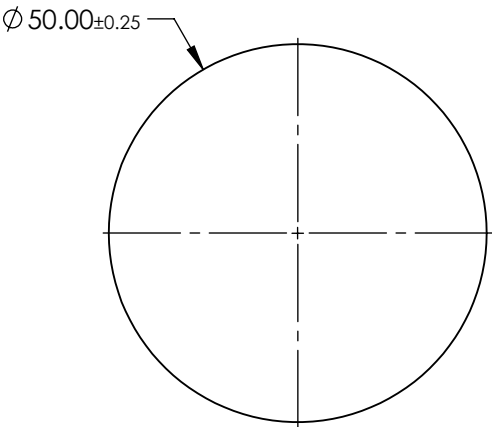

**FOR INFORMATION ONLY:
DO NOT MANUFACTURE
PARTS TO THIS DRAWING**

SPECIFICATIONS SUBJECT TO CHANGE WITHOUT NOTICE
DIMENSIONS ARE FOR REFERENCE ONLY

	S1	S2	<div><div><div><div></div></div></div><div><div>Edmund Optics®</div></div></div>			
SHAPE	PLANO	PLANO	<div><div>THIRD ANGLE PROJECTION</div><div><div></div></div></div>			
SURFACE QUALITY	80 - 50	COMMERCIAL POLISH				
CLEAR APERTURE	Ø45.00	N/A				
SURFACE FLATNESS	4 - 6λ	N/A				
BEVEL	PROTECTED AS NEEDED	PROTECTED AS NEEDED	ALL DIMS IN	mm	DWG NO	SHEET 1 OF 1

Edmund Optics®

MIRROR 4-6 WAVE RH 50mm DIA

15491