

NOTES:

- 1. SUBSTRATE:
FUSED SILICA
- 2. SURFACE S2 TO BE PARALLEL TO SURFACE S1 TO WITHIN < 3 ARCMIN
- 3. COATING PERFORMANCES ACROSS CLEAR APERTURE:
T(ABS) > 99.8% @ 1064nm @ 0° AOI
- 4. SURFACES ARE EXTREMELY FRAGILE, ANY CONTACT TO OPTICAL SURFACE WILL AFFECT PERFORMANCE. DO NOT TOUCH SURFACES AND DO NOT WIPE CLEAN.

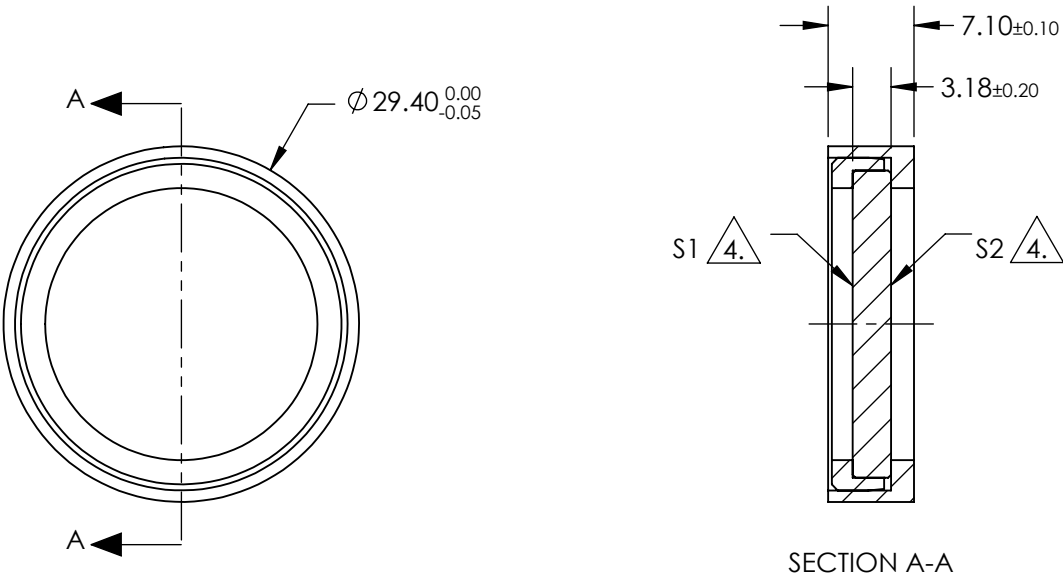

**FOR INFORMATION ONLY:
DO NOT MANUFACTURE
PARTS TO THIS DRAWING**

SPECIFICATIONS SUBJECT TO CHANGE WITHOUT NOTICE
DIMENSIONS ARE FOR REFERENCE ONLY

Edmund Optics®

	S1	S2	THIRD ANGLE PROJECTION		TITLE	MOUNTED 1" NEBULAR™ 1064nm WINDOW	
SHAPE	PLANO	PLANO	ALL DIMS IN	mm	DWG NO	14598	SHEET 1 OF 1
SURFACE QUALITY	10-5	10-5					
CLEAR APERTURE	Ø20.32	Ø20.32					