

FOCAL LENGTH (EFL): 250 ±2,5  
BACK FOCAL LENGTH (BFL): 248,02



LEFT SURFACE AR COATING:  
NIR II

R(ABS) ≤ 1,5% FROM 750-800nm @ 0° AOI  
R(ABS) ≤ 1,0% FROM 800-1550nm @ 0° AOI  
R(AVG) ≤ 0,7% FROM 750-1550nm @ 0° AOI

RIGHT SURFACE AR COATING:  
NIR II

R(ABS) ≤ 1,5% FROM 750-800nm @ 0° AOI  
R(ABS) ≤ 1,0% FROM 800-1550nm @ 0° AOI  
R(AVG) ≤ 0,7% FROM 750-1550nm @ 0° AOI

LEFT SURFACE		MATERIAL	RIGHT SURFACE	
R	129,2 CX	GLASS N-BK7 Nd: 1,517 Vd: 64,2	R	∞ PL
Øe	14		Øe	14
3/	3 (0,5) λ=632,8 nm		3/	3 (0,5) λ=632,8 nm
4/	-		4/	1,93'
5/	40 - 20		5/	40 - 20
6/	-		6/	-

PROTECTIVE CHAMFERS AS NEEDED

ROHS:  
COMPLIANT

SCALE:  
NONE

λ = 587,6nm

FIRST ANGLE  
PROJECTION

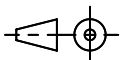

SPECIFICATIONS SUBJECT TO CHANGE WITHOUT  
NOTICE. DIMENSIONS ARE FOR REFERENCE ONLY

FOR INFORMATION ONLY: DO NOT MANUFACTURE  
PARTS TO THIS DRAWING

INDICATIONS IN ACCORDANCE WITH ISO 10110

ALL DIMS  
IN:

mm



Edmund Optics®

TITLE

15mm Dia x 250mm FL, NIR II Coated,  
Plano-Convex Lens

DWG NO

14386

SHEET  
SIZE A4

SHEET  
1 OF 1