

NOTES:

- 1. SUBSTRATE:
Fused Silica
- 2. COATING (APPLY ACROSS COATING APERTURE):
S1 & S2: NONE
- 3. EFFECTIVE FOCAL LENGTH: 0.80 mm
- 4. DIVERGENCE ANGLE: $\pm 10.1^\circ$
- 5. WAVELENGTH RANGE (nm): 200 - 2200
- 6. ROHS: COMPLIANT

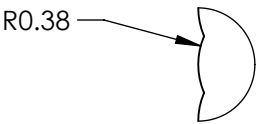

DETAIL A

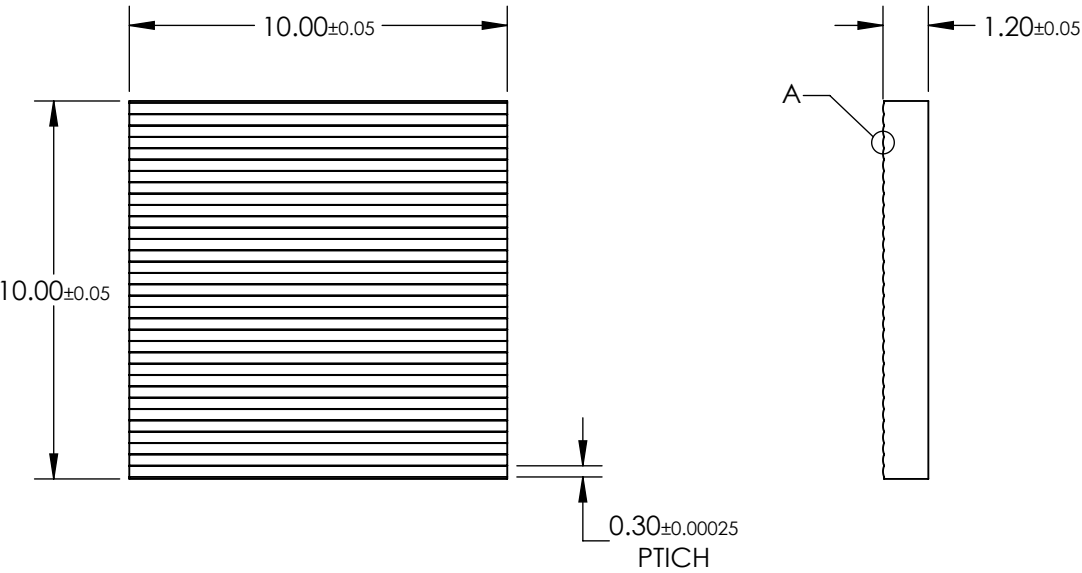

SPECIFICATIONS SUBJECT TO CHANGE WITHOUT NOTICE
DIMENSIONS ARE FOR REFERENCE ONLY

**FOR INFORMATION ONLY:
DO NOT MANUFACTURE
PARTS TO THIS DRAWING**

Edmund Optics®

THIRD ANGLE PROJECTION		TITLE	10 x 10mm, 300µm Pitch, 10.1° Divergence, Cyl. Microlens Array	
ALL DIMS IN	mm	DWG NO	86841	SHEET 1 OF 1