

1. SUBSTRATE:  
Fused Silica

- S1: R(ABS) >99.8% @ 1030nm  
DAMAGE THRESHOLD,  
PULSED: 15 J/cm<sup>2</sup> @ 1030nm, 20ns, 20Hz

#### 4. FINE GROUND SURFACE

7. ARROW ON EDGE WITH LASER ETCH, PENCIL, OR PERMANENT INK POINTS TOWARDS SURFACE S1

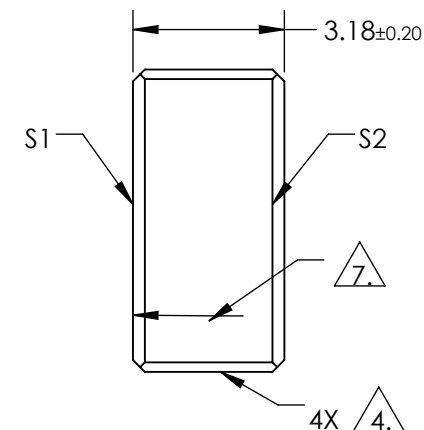
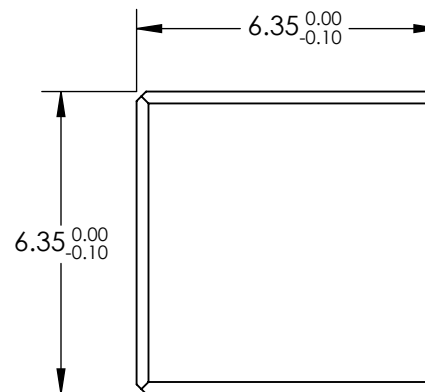

**FOR INFORMATION ONLY:  
DO NOT MANUFACTURE  
PARTS TO THIS DRAWING**

	S1	S2
SHAPE	PLANO	PLANO
SURFACE QUALITY	10-5	COMMERCIAL POLISH
SURFACE FLATNESS	0.10 WAVE	N/A
MIN CLEAR APERTURE	5.40 x 5.40	N/A
MIN COATNG APERTURE	5.40 x 5.40	N/A
BEVEL	PROTECTIVE AS NEEDED	PROTECTIVE AS NEEDED



ALL DIMS IN	mm
-------------	----

 Edmund Optics®

TITLE	6.35 x 6.35mm 1030nm 0-45°, Yb:YAG Laser Line Mirror
-------	---

DWG NO	11309
--------	-------

SHEET  
1 OF 1