

NOTES:

1. SUBSTRATE:  
Fused Silica
2. SURFACE S1 TO BE PARALLEL TO SURFACE S2 TO WITHIN <3 ARCMINS
3. COATING (APPLY ACROSS COATING APERTURE)

S1: R(ABS) >99.8% @ 1030nm  
DAMAGE THRESHOLD,  
PULSED: 20 J/cm² @ 1030nm, 20ns, 20Hz  
CW: 1 MW/cm² @ 1030nm

S2: NONE

4. FINE GROUND SURFACE
5. CLEAR APERTURE AND COATING APERTURE ARE CENTERED ON SURFACE
6. POWER, IRREGULARITY, AND SURFACE QUALITY SPECIFICATIONS APPLY ACROSS CLEAR APERTURE
7. ARROW ON EDGE WITH LASER ETCH, PENCIL, OR PERMANENT INK POINTS TOWARDS SURFACE S1

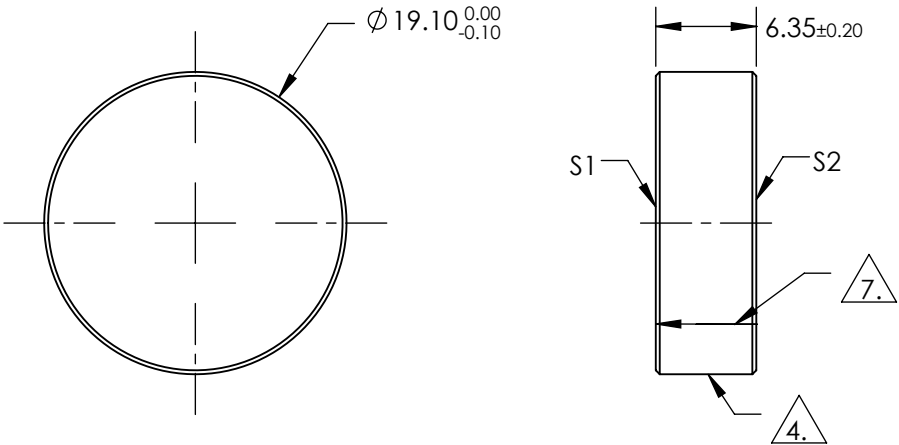

**FOR INFORMATION ONLY:  
DO NOT MANUFACTURE  
PARTS TO THIS DRAWING**

SPECIFICATIONS SUBJECT TO CHANGE WITHOUT NOTICE  
DIMENSIONS ARE FOR REFERENCE ONLY

|                      | S1                   | S2                   |                                                                                                                                                   |    |              |       |
|----------------------|----------------------|----------------------|---------------------------------------------------------------------------------------------------------------------------------------------------|----|--------------|-------|
| SHAPE                | PLANO                | PLANO                | <div><div>THIRD ANGLE<br/>PROJECTION</div><div></div></div> <div>Edmund Optics®</div> <div>19.1mm Dia. 1030nm 45°, Yb:YAG Laser Line Mirror</div> |    |              |       |
| SURFACE QUALITY      | 10-5                 | COMMERCIAL POLISH    |                                                                                                                                                   |    |              |       |
| SURFACE FLATNESS     | 0.10 WAVE            | N/A                  |                                                                                                                                                   |    |              |       |
| MIN CLEAR APERTURE   | Ø17.19               | N/A                  |                                                                                                                                                   |    |              |       |
| MIN COATING APERTURE | Ø17.19               | N/A                  |                                                                                                                                                   |    |              |       |
| BEVEL                | PROTECTIVE AS NEEDED | PROTECTIVE AS NEEDED | ALL DIMS IN                                                                                                                                       | mm | DWG NO       | 11293 |
|                      |                      |                      |                                                                                                                                                   |    | SHEET 1 OF 1 |       |