

NOTES:

1. SUBSTRATE
FUSED SILICA
2. SURFACE S2 TO BE PARALLEL TO SURFACE S1 TO WITHIN <3 ARCMIN
3. COATING (APPLY ACROSS COATING APERTURE):

S1: 355 HR Coating
R (ABS) > 99.80% @ 355nm @ 0-45° AOI

DAMAGE THRESHOLD,
PULSED: 5 J/cm², 20ns, 20Hz @ 355nm
CW: 1MW/cm² @ 355nm

S2: NONE

4. FINE GRIND SURFACE
5. POWER, IRREGULARITY, AND SURFACE QUALITY SPECIFICATIONS APPLY
ACROSS CLEAR APERTURE
6. CLEAR APERTURE AND COATING APERTURE ARE CENTERED ON SURFACES
7. APPLY ARROW ON EDGE WITH LASER ETCH, PENCIL, OR PERMANENT INK
POINTING TOWARDS SURFACE S1

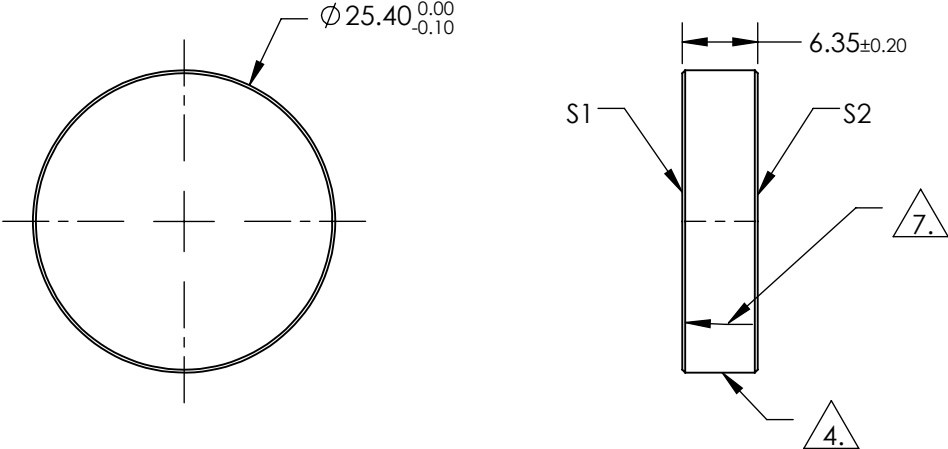

**FOR INFORMATION ONLY:
DO NOT MANUFACTURE
PARTS TO THIS DRAWING**

SPECIFICATIONS SUBJECT TO CHANGE WITHOUT NOTICE
DIMENSIONS ARE FOR REFERENCE ONLY

	S1	S2	<div><div><div><div></div></div></div><div>Edmund Optics®</div></div> <div><div>THIRD ANGLE PROJECTION</div><div></div><div>TITLE</div><div>Ø25.4mm x 6.35mm, 355nm, NdYAG MIRROR 0-45° AOI</div></div>			
SHAPE	PLANO	PLANO				
SURFACE QUALITY	10-5	COMMERCIAL POLISH				
SURFACE FLATNESS	0.10 WAVE	N/A				
MIN CLEAR APERTURE	Ø22.86	N/A				
MIN COATING APERTURE	Ø22.86	N/A				
BEVEL	PROTECTIVE AS NEEDED	PROTECTIVE AS NEEDED				
			ALL DIMS IN	mm	DWG NO	38866
						SHEET 1 OF 1