

NOTES:

1. SUBSTRATE:
Fused Silica 458/678
2. ROHS COMPLIANT
3. CENTERING TOLERANCE (AT 587.6nm):
BEAM DEVIATION (HALF ANGLE): <1 ARCMIN
4. COATING (APPLY ACROSS COATING APERTURE)

S1 & S2: 1064nm Laser AR Coating
R(ABS) < 0.25% @ 1064nm @ 0° AOI

DAMAGE THRESHOLD
PULSED: 15J/cm² @ 20ns, 20Hz @ 1064nm

 FINE GRIND SURFACE

6. POWER, IRREGULARITY, AND SURFACE QUALITY
SPECIFICATIONS APPLY ACROSS CLEAR APERTURE
7. FOCAL LENGTH (EFL): 500.00mm±1%
BACK FOCAL LENGTH (BFL): 497.44mm
8. PROTECTIVE BEVEL AS NEEDED
9. DESIGN WAVELENGTH: 355nm

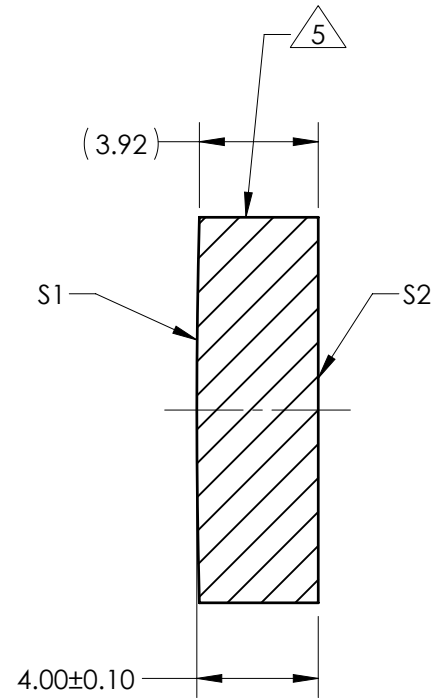

SECTION A-A

FOR INFORMATION ONLY:
**DO NOT MANUFACTURE
PARTS TO THIS DRAWING**

| | S1 | S2 |
|-------------------------|------------|------------|
| SHAPE | CONVEX | PLANO |
| RADIUS | 238.04 | INFINITY |
| SURFACE QUALITY | 10 - 5 | 10 - 5 |
| MIN CLEAR APERTURE | Ø 11.70 | Ø 11.70 |
| MIN COATING APERTURE | Ø 11.70 | Ø 11.70 |
| POWER AT 632.8nm | 2.00 RINGS | 2.00 RINGS |
| IRREGULARITY AT 632.8nm | 0.20 RINGS | 0.20 RINGS |

SPECIFICATIONS SUBJECT TO CHANGE WITHOUT NOTICE
DIMENSIONS ARE FOR REFERENCE ONLY

 **Edmund Optics®**

| | | | |
|--------|---|--|-----------------|
| TITLE | 12.7mm Dia x 500mm FL, 1064nm Laser AR Coating, 15J Coated, Plano-Convex Lens | | |
| DWG NO | 38742 | | SHEET 1 OF 1 |

THIRD ANGLE
PROJECTION

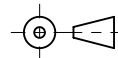

ALL DIMS IN

mm