

NOTES:

1. SUBSTRATE MATERIAL:
N-SF5
2. COATING (APPLY ACROSS CLEAR APERTURE)

S1: ENHANCED ALUMINUM
R(avg) >95% @ 450 - 650nm

S2: NONE
3. POWER, IRREGULARITY, SURFACE QUALITY, AND COATING
SPECIFICATIONS APPLY ACROSS CLEAR APERTURE
4.

FINE GROUND SURFACE
5. ROHS COMPLIANT

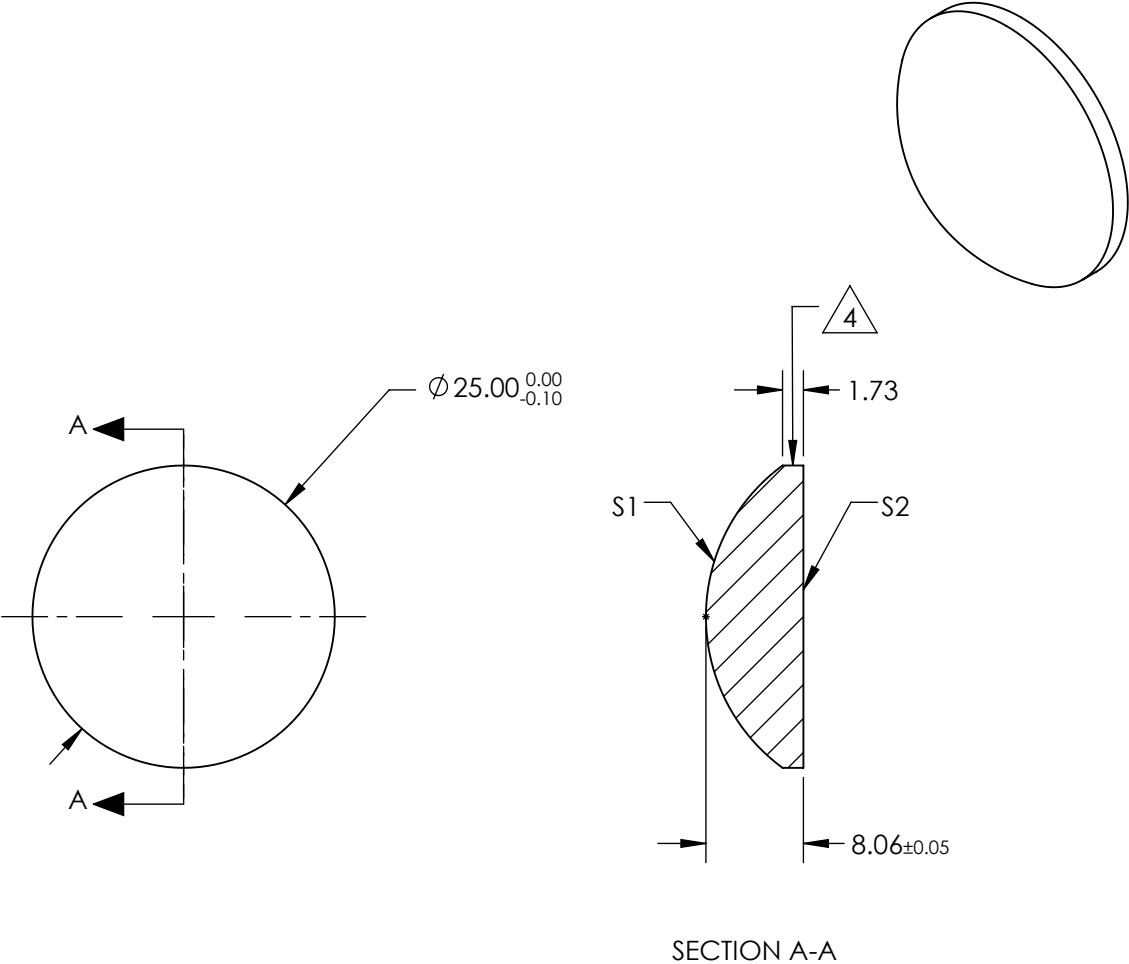

**FOR INFORMATION ONLY:
DO NOT MANUFACTURE
PARTS TO THIS DRAWING**

SPECIFICATIONS SUBJECT TO CHANGE WITHOUT NOTICE
DIMENSIONS ARE FOR REFERENCE ONLY

REV. A		S1	S2	<div><div></div><div>Edmund Optics®</div></div>					
SHAPE		CONVEX	PLANO						
RADIUS		15.5	INFINITY						
EFFECTIVE FOCAL LENGTH		-7.75mm	N/A						
FOCAL LENGTH TOLERANCE		±2%	N/A	<div>THIRD ANGLE PROJECTION</div> <div></div>		TITLE		Ø25mm, -7.75mm FL ENHANCED ALUMINUM, CONVEX SPHERICAL MIRROR	
SURFACE QUALITY		60-40	COMMERCIAL POLISH						
CLEAR APERTURE		90%	N/A						
BEVEL		PROTECTIVE AS NEEDED	PROTECTIVE AS NEEDED	ALL DIMS IN	mm	DWG NO	64060	SHEET 1 OF 1	