

NOTES:

1. SUBSTRATE
- FUSED SILICA
2. SURFACE S2 TO BE PARALLEL WITH S1 WITHIN < 3 ARCMIN
3. COATING (APPLY ACROSS CLEAR APERTURE)
- S1: Laser Mirror (532nm)
- R(ABS) >99.8% @ 532nm @ 0-45° AOI
- DAMAGE THRESHOLD,
- PULSED: 10 J/cm² @ 532nm, 20ns, 20Hz

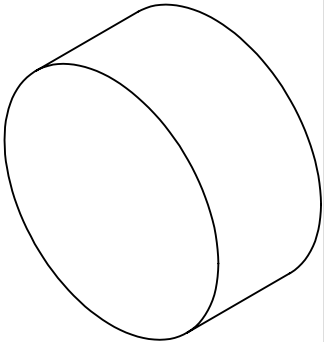

S2: NONE

4. FINE GROUND SURFACE

5. POWER, IRREGULARITY, SURFACE QUALITY, AND COATING SPECIFICATIONS APPLY ACROSS CLEAR APERTURE
6. RoHS COMPLIANT

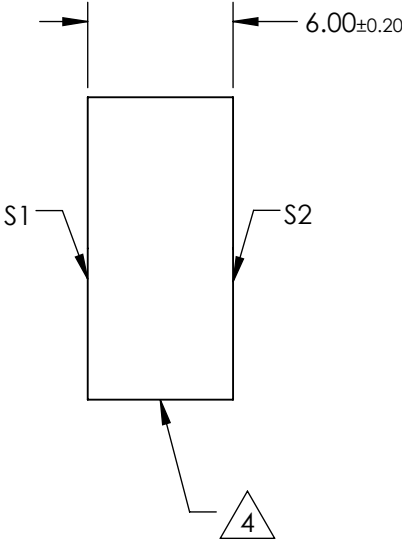
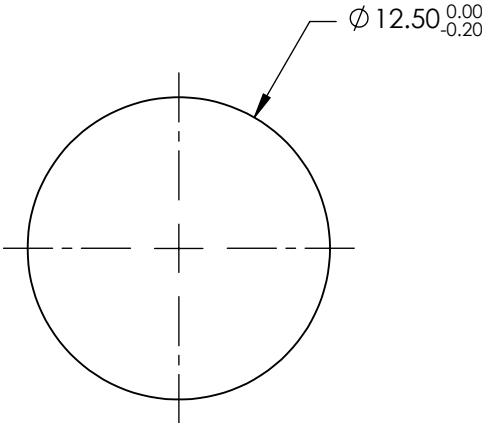

**FOR INFORMATION ONLY:  
DO NOT MANUFACTURE  
PARTS TO THIS DRAWING**

SPECIFICATIONS SUBJECT TO CHANGE WITHOUT NOTICE  
DIMENSIONS ARE FOR REFERENCE ONLY

	S1	S2
SHAPE	PLANO	PLANO
SURFACE FLATNESS	$\lambda/10$	N/A
SURFACE QUALITY	10-5	FINE GROUND
CLEAR APERTURE	Ø11.25	N/A
BEVEL	PROTECTIVE AS NEEDED	PROTECTIVE AS NEEDED

THIRD ANGLE  
PROJECTION

TITLE

Ø12.5mm, 532nm, 0 - 45°, ND:YAG LASER LINE MIRROR

DWG NO

88529

SHEET

1 OF 1

Edmund Optics®