

NOTES:

1. SUBSTRATE
- FUSED SILICA
2. SURFACE S2 TO BE PARALLEL WITH S1 WITHIN < 3 ARCMIN
3. COATING (APPLY ACROSS CLEAR APERTURE)
- S1: Laser Mirror (355nm)
- R(ABS) >99.8% @ 355nm @ 0-45° AOI
- DAMAGE THRESHOLD,
- PULSED: 5.0 J/cm² @ 355nm, 20ns, 20Hz

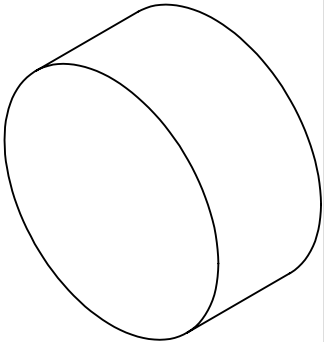

S2: NONE

4. FINE GROUND SURFACE

5. POWER, IRREGULARITY, SURFACE QUALITY, AND COATING SPECIFICATIONS APPLY ACROSS CLEAR APERTURE
6. RoHS COMPLIANT

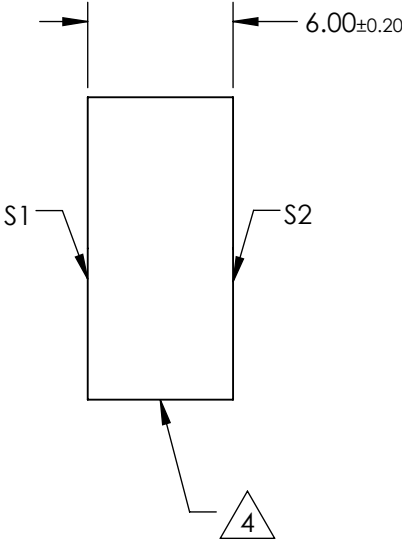
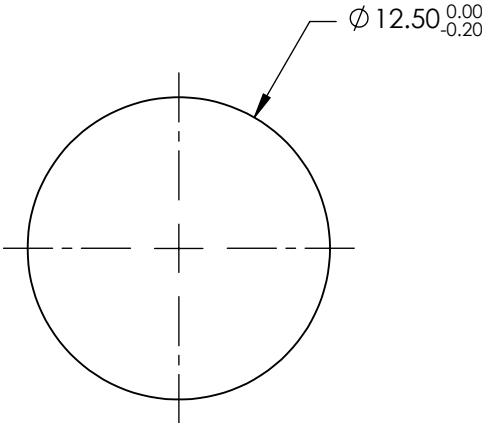

**FOR INFORMATION ONLY:
DO NOT MANUFACTURE
PARTS TO THIS DRAWING**

SPECIFICATIONS SUBJECT TO CHANGE WITHOUT NOTICE
DIMENSIONS ARE FOR REFERENCE ONLY

	S1	S2	<div><div><div><div></div><div></div></div><div>Edmund Optics®</div></div><div><div>THIRD ANGLE PROJECTION</div><div></div></div><div><div>TITLE</div><div>Ø12.5mm, 355nm, 0 - 45°, ND:YAG LASER LINE MIRROR</div></div><div><div>ALL DIMS IN</div><div>mm</div></div><div><div>DWG NO</div><div>88526</div></div><div><div>SHEET</div><div>1 OF 1</div></div></div>			
SHAPE	PLANO	PLANO				
SURFACE FLATNESS	λ/10	N/A				
SURFACE QUALITY	10-5	FINE GROUND				
CLEAR APERTURE	Ø11.25	N/A				
BEVEL	PROTECTIVE AS NEEDED	PROTECTIVE AS NEEDED				