

NOTES:

1. SUBSTRATE: Germanium (Ge)
2. SURFACE S2 TO BE PARALLEL WITH SURFACE S1 TO <10 ARCMIN
3. COATING (APPLY ACROSS CLEAR APERTURE)  
OPTICAL DENSITY = 1.5 @ 2 - 14  $\mu$ m  
TRANSMISSION = 3.2 @ 2 - 14  $\mu$ m
4. FINE GRIND SURFACE
5. POWER, IRREGULARITY, AND SURFACE QUALITY SPECIFICATIONS  
APPLY ACROSS CLEAR APERTURE
6. ROHS COMPLIANT

**FOR INFORMATION ONLY:  
DO NOT MANUFACTURE  
PARTS TO THIS DRAWING**

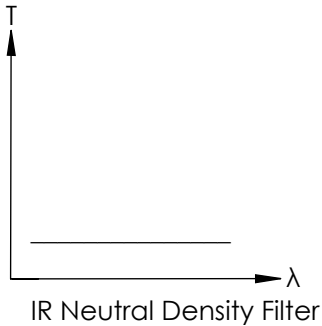
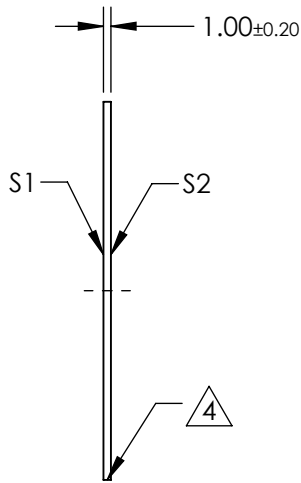
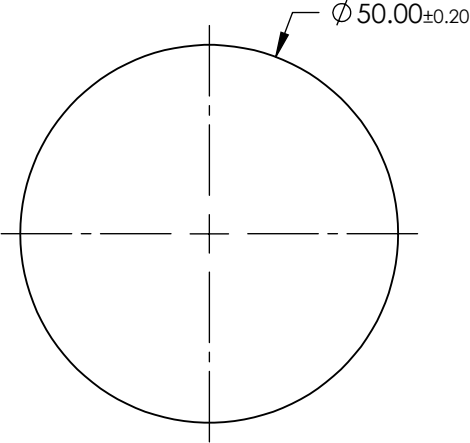
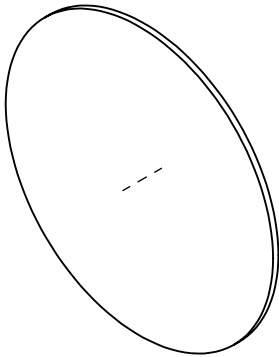

SPECIFICATIONS SUBJECT TO CHANGE WITHOUT NOTICE  
DIMENSIONS ARE FOR REFERENCE ONLY

	S1	S2
SHAPE	PLANO	PLANO
SURFACE FLATNESS	3 - 5 $\lambda$	3 - 5 $\lambda$
SURFACE QUALITY	80-50	80-50
CLEAR APERTURE	$\phi$ 45	$\phi$ 45
BEVEL	PROTECTED AS NEEDED	PROTECTED AS NEEDED

THIRD ANGLE  
PROJECTION

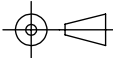

ALL DIMS IN

mm



**Edmund Optics®**

TITLE

1.5 OD, 50mm Dia., IR Neutral Density Filter

DWG NO

87204

SHEET  
37 OF 37